

technics

Diapason, Diapason Cover

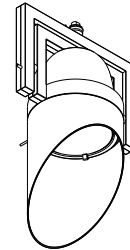
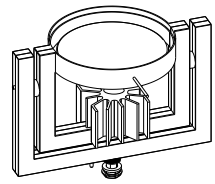

Name

Reference

L x W x D

Diapason

kr97612x / kr97658x /  
kr97611x

125 x 182 Ø13

kr97613x / kr97653x /

120 x 182 Ø13

Diapason cover

kr98611x / kr97657x  
kr97652x / kr97651x

125 x 182 Ø13

1 dimensions

diapason

diapason cover

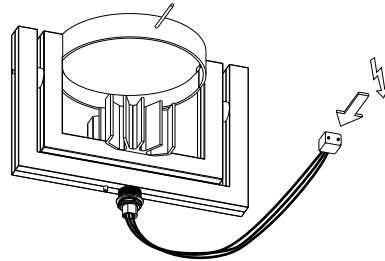

Name

Reference

Voltage ⚡

Diapason

kr97612x / kr97611x  
kr97658x  
kr97613x  
kr97653x

12V  
230V / 1,5kV  
230V  
230V / 5kV

Diapason cover

kr98611x  
kr97657x  
kr97652x / kr97651x

12V  
230V  
230V / 5kV

Please make sure that  
mains voltage is disconnected  
before proceeding! ⚡

2 connection

apply correct voltage

installation of  
diapason

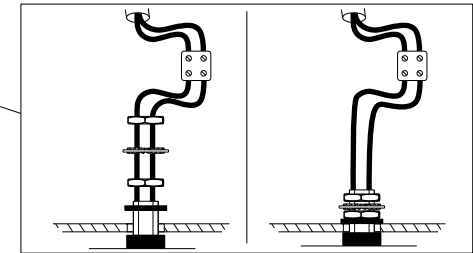
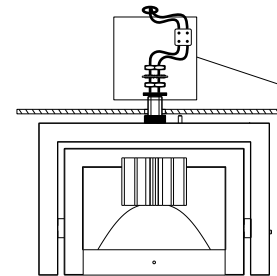
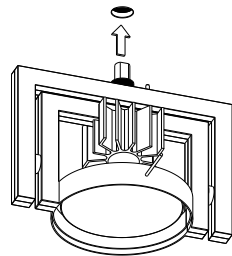

3 installation

provide 10mm hole

base is optional in tile system

base is required in gypsum system

Ø 5 mm

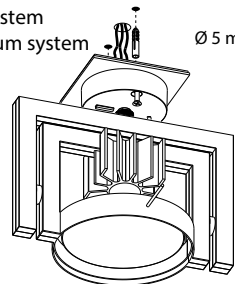

base: check instructions on base  
manual (kr8765001535) for correct  
installation.

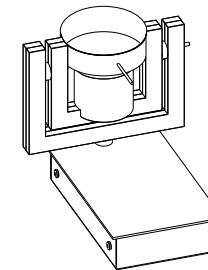

gearbox : check instructions  
on gearbox manual (kr8965001357)  
for correct installation.

4 installation

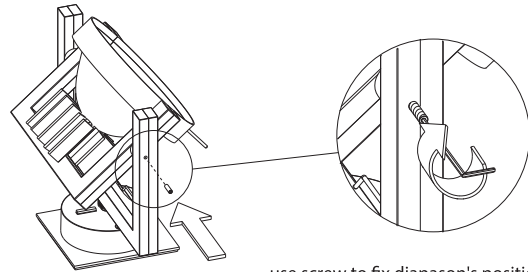

5 installation

use screw to fix diapason's position

lamp installation of diapason cover

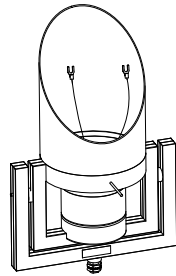
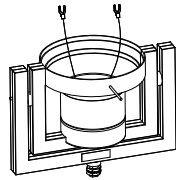

Install glare preventer

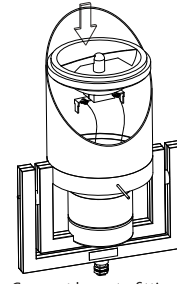

Connect lamp to fitting and push lamp downwards

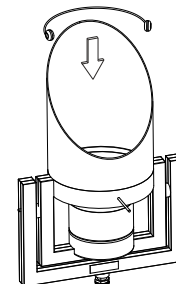

Push fixation spring downwards

6 installation

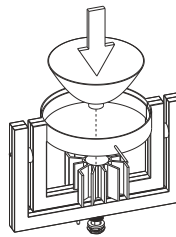

reflector : push in cooling profile

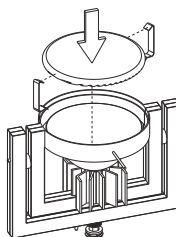

lens, glass or filter : fix to frame with springs

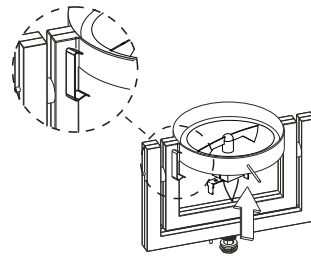

fixate QR-LP111 lamp with springs

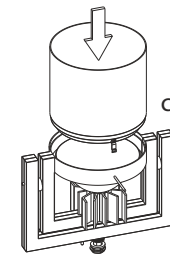

glare preventer : push until it snaps

click!

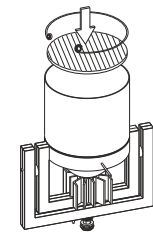

glare preventer + lens, glass or filter: use fixation spring

7 accessories

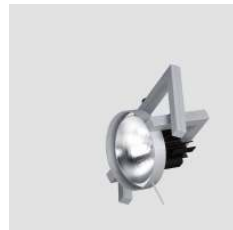

8 picture

kreon nv

Industrieweg Noord 1152  
3660 Opglabbeek  
Belgium

Tel + 32 89 81 97 80  
Fax + 32 89 81 97 90

www.kreon.com  
mailbox@kreon.be

Rev. date: 11/07/2013  
KR8061031380