

# Bach

Massimiliano Raggi



SMALL



LARGE



Lampada a parete, in due dimensioni, caratterizzate dall'alternarsi di tubi in metallo ed in plexiglass (ricorda le canne di un organo). Prodotto molto eclettico adatto per uso residenziale e contract: sia in un elegante salotto o nelle aree comuni e nel corridoio di un hotel. Un modello geometrico nascosto dietro ai tubi arricchisce gli effetti di luce, creando un gioco di ombre e sfumature sulle parti in plexiglass.

*Wall lamp, in two sizes, characterized by the alternation of metal and plexiglass tubes (it reminds of organ pipes). Very eclectic product suitable for residential and contract use: both in an elegant living room as well as in the public areas and in the corridor of a hotel. A geometric model hidden behind the tubes enriches the light effects, creating a play of shadows and shades on the plexiglass parts.*

SPECIFICHE PRODOTTO / PRODUCT SPECIFICS

p.2

BACH SMALL

p.3

BACH LARGE

p.4

## STRUTTURA / FRAME



Laccato oro  
*Gold lacquered*

## DIFFUSORE / DIFFUSER



Plexiglass satinato  
*Satin plexiglass*

## FONTE LUMINOSA / LIGHT SOURCE

### 220-240V



GU10 LED

**SMALL / LARGE**  
2 x 9W GU10  
Lampadine LED  
*LED light bulbs*  
IP20

Compatibile con sistemi di controllo remoto  
in caso di utilizzo di lampadine LED dimmerabili

*Compatible with remote control systems  
when dimmable LED bulbs are used*



### 110V



GU10 LED

**SMALL / LARGE**  
2 x 9W GU10  
LED light bulbs  
IP20

Compatible with remote control systems  
when dimmable LED bulbs are used



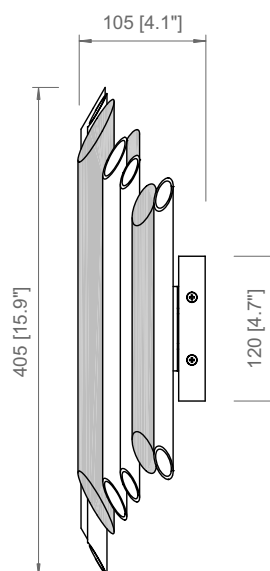
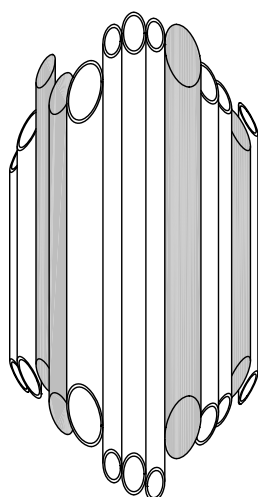
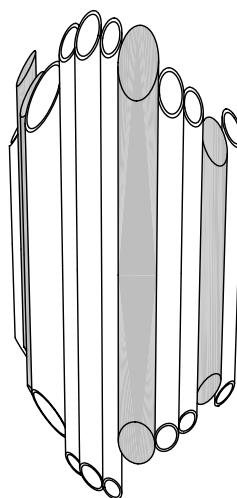
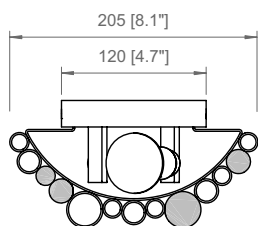

**PRODOTTO / PRODUCT**   **IMBALLI / PACKAGING**

**Peso-Weight**  
3 kg / 6.6 lbs

**Box 1**  
L: 420 mm / 16.5"  
P-W: 420 mm / 16.5"  
H: 160 mm / 6.3"  
Peso-Weight: 4 kg / 8.8 lbs

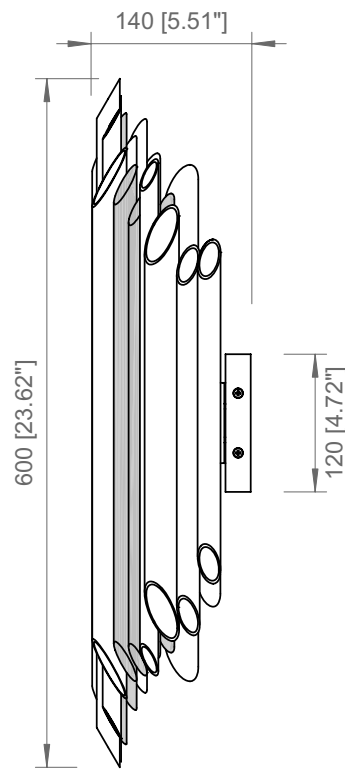
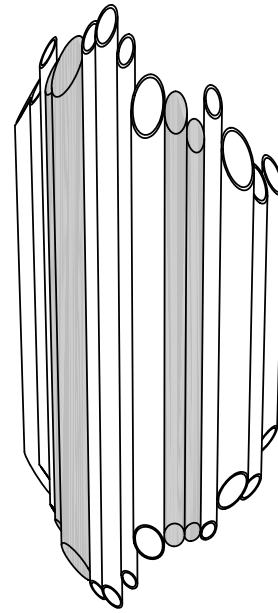
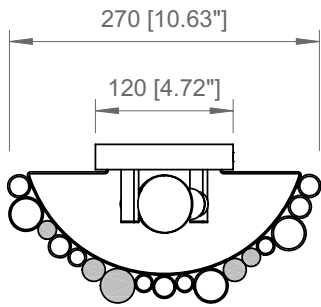

**PRODOTTO / PRODUCT**   **IMBALLI / PACKAGING**

**Peso-Weight**  
6.5 kg / 14.3 lbs

**Box 1**  
L: 510 mm / 20"  
P-W: 510 mm / 20"  
H: 260 mm / 10.2"  
Peso-Weight: 7.5 kg / 16.5 lbs

Copyright and/or design rights subsist in this drawing. No part of this drawing may be reproduced in any material form (including photocopying or storing in any medium electronic means, whether or not intentionally and whether or not as part or a larger publication) without the express permission of the copyright owner, Contardi Lighting S.r.l.. Further and without prejudice to the above, this drawing and all information relating thereto is confidential, and shall not be communicated to a third party without the consent of Contardi lighting srl. Contardi lighting srl asserts all rights to be identified as the author of the work and otherwise.

WARNING: The doing of any unauthorised act in relation to a copyright work may result in both a civil claim for damages and criminal prosecution.

---

**CONTARDI LIGHTING Srl**

ITALY HEADQUARTERS

[www.contardi-italia.com](http://www.contardi-italia.com) / [sales@contardi-italia.it](mailto:sales@contardi-italia.it)

**CONTARDI USA Inc**

USA BRANCH

[www.contardi-usa.com](http://www.contardi-usa.com) / [sales@contardi-usa.com](mailto:sales@contardi-usa.com)

