

Technics

IN CASE OF SURFACE MOUNTED PROFILE

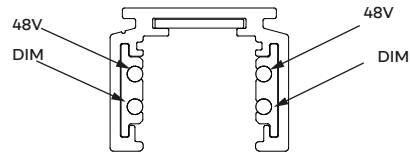
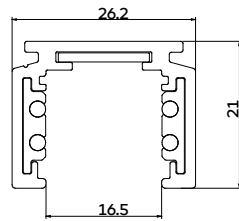

Name	Reference
Surface mounted track	KR7460xx
End cap	KR74650x
Power supply	KR79047x

The tracks and accessories illustrated are buy in parts from Stucchi a.a.g. Please read official Stucchi safety warnings and product installation manual provided with the tracks. Kreon is not responsible for the safety and functioning of the products shown. This installation manual is purely informative.

1 Dimensions

Please make sure the main voltage is disconnected before proceeding!

Provide 48V cables
Use cables 1.5mm²
The max. current is 15A
Place power supply on remote

In case of dimming (1-10V or Dali)
provide dimming cables

Provide mounting points
Use suitable plugs for ceiling and screws used

2 mounting holes for fist meter
1 extra for each extra meter

The max. load is 25kg per meter

2 Installation

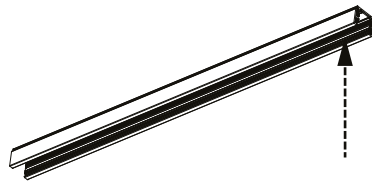

Cut profile to the correct length
Make hole for cables to disappear through

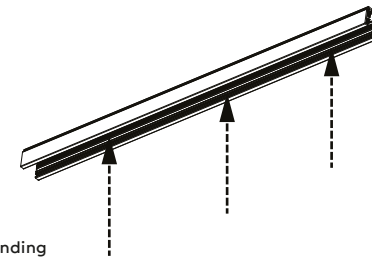

Make holes for scw mounting corresponding with the holes made in the ceiling

3 Installation



Make sure copper wires are recessed
When the profile is cut to size the 4 internal copper wires are not recessed. Special tool kr746920 can be used to cut them.

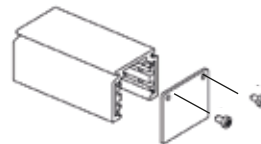

Assemble end-caps

Pull power cables through the hole made

Mount profile with screws

It is recommended to use countersunk screws

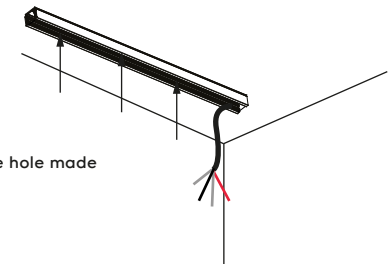

Technics

IN CASE OF PENDANT MOUNTED PROFILE

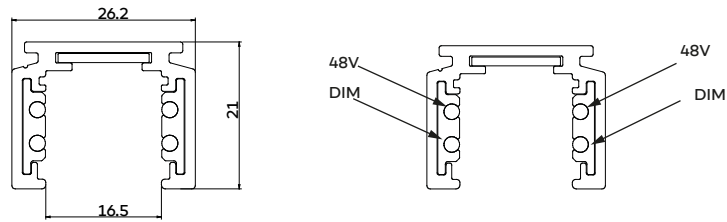

Name	Reference
Surface mounted track	KR7460xx
Pendant clip for suspension	KR74691x
Suspension steel wire	KR746x10
End cap	KR74650x
Power supply	KR79047x

The tracks and accessories illustrated are buy in parts from Stucchi a.a.g. Please read official Stucchi safety warnings and product installation manual provided with the tracks. Kreon is not responsible for for the safety and functioning of the products shown. This installation manual is purely informative.

4 Dimensions

Please make sure the main voltage is disconnected before proceeding!

Provide 48V cables
Use cables 1.5mm²
The max. current is 15A
Place power supply on remote

In case of dimming (1-10V or Dali)
provide dimming cables

Install wire grips
Use suitable plugs for ceiling and screws used

2 wire grips for fist meter
1 extra for each extra meter

The max. load is 25kg per meter

5 Installation

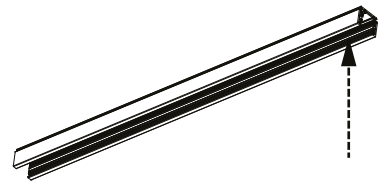

Cut profile to the correct length
Make hole for cables to disappear through

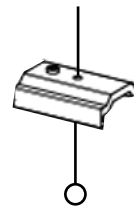

Pull steel wire with ball through the suspension bracket

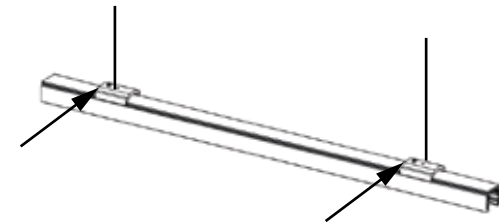

Slide brackets over the track and fix them in place by fastening the set screw

6 Installation



Make sure copper wires are recessed
When the profile is cut to size the 4 internal copper wires are not recessed. Special tool kr746920 can be used to cut them.

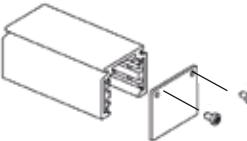

Assemble end-caps

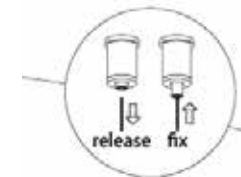

Assemble cables in wire grippers and install them at the correct length
Pull power cables through hole made

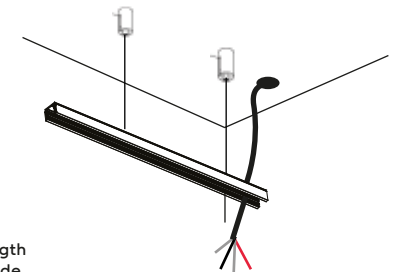

Technics

IN CASE OF RECESSED MOUNTED PROFILE

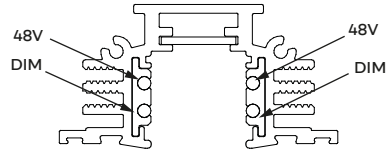
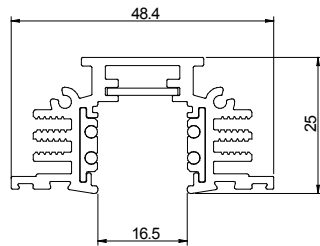

Name	Reference
Recessed mounted track	KR7461x0
Mounting bracket	KR746900
Reinforcing bracket	KR746800
End cap	KR74650x
Power supply	KR79047x

The tracks and accessories illustrated are buy in parts from Stucchi a.a.g. Please read official Stucchi safety warnings and product installation manual provided with the tracks. Kreon is not responsible for for the safety and functioning of the products shown. This installation manual is purely informative.

7 Dimensions

Please make sure the main voltage is disconnected before proceeding!

Provide 48V cables
Use cables 1.5mm²
The max. current is 15A
Place power supply on remote

In case of dimming (1-10V or Dali)
provide dimming cables

Provide a cut 50mm wide

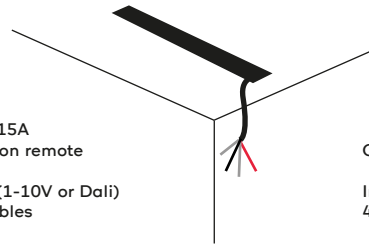

Cut the profile to the correct length

Install mounting brackets to the profile
4 brackets per meter

The max. load is 20kg per meter



8 Installation

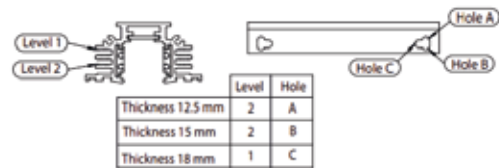

The profile can be mounted to 3 plasterboard thicknesses depending on the level and hole used to mount the bracket



Make sure copper wires are recessed
When the profile is cut to size the 4 internal copper wires are not recessed. Special tool kr746920 can be used to cut them.

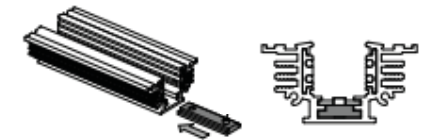

The reinforcing bracket can be used to mechanically connect two profiles

Slide it in the profiles and fasten it in place with the two set screws

9 Installation

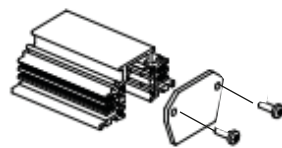

Assemble end-caps

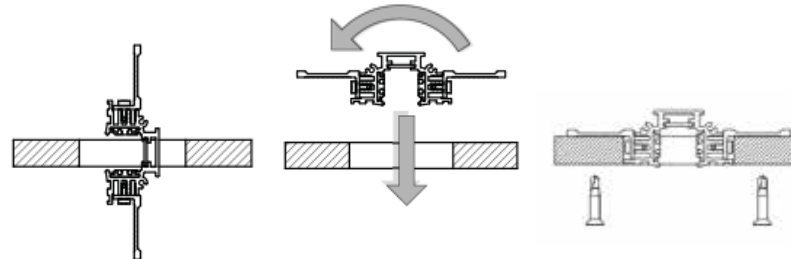

Put the profile in the ceiling, the mounting brackets should rest on the plasterboard. Screw the profile in place and plaster the edges to finish.

kreon

Technics

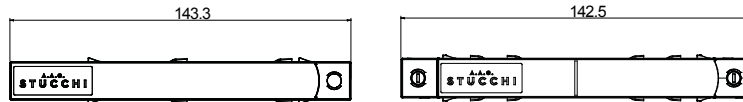

Name	Reference
End feed	KR74651x
Straight connector	KR74653x

The tracks and accessories illustrated are buy in parts from Stucchi a.a.g.
Please read official Stucchi safety warnings and product installation manual provided with the tracks.
Kreon is not responsible for for the safety and functioning of the items produced.
This installation manual is purely informative.

10 Dimensions

End- feed

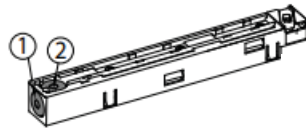

Push open cable hole of choise

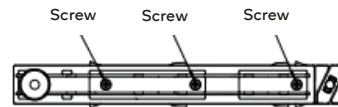

Open box by removing lid fastened with 3 screws

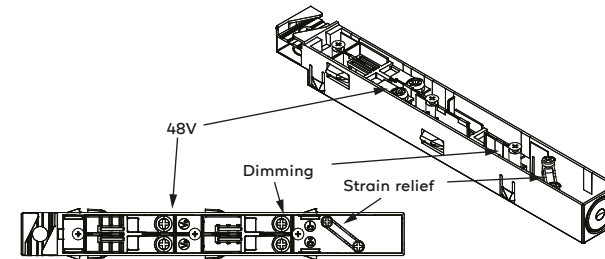

Pull stripped cables through the chosen cable hole
Connect 48V cables to screw connctetos indicated with V+ and V-
Connect dim cables to screw connctros indicated with D+ and D-

In both cases + and - can be swapped
Fasten all cables with the strain relief
Screw the lid on the box

11 Installation

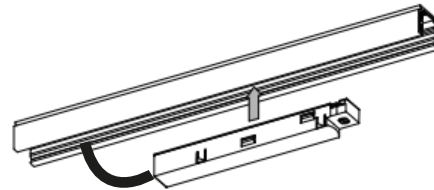

Push cables back through hole in track and click end-feed in the track

+ and - can be swapped
End-feed can be used left or right
it can be rotated 180°



End-feed needs to be 100% flush with the profile

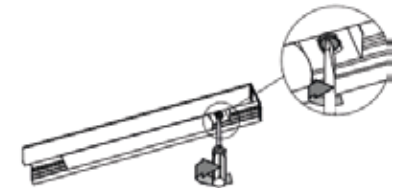

Fix it in place by turning the mechanical twist lock with a screwdriver

12 Installation

Straight connector

In case of two profiles next to each other use straight connector to make electrical connection

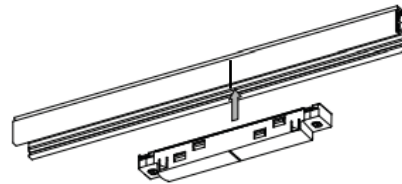

Push straight connector in profiles where the splitline is

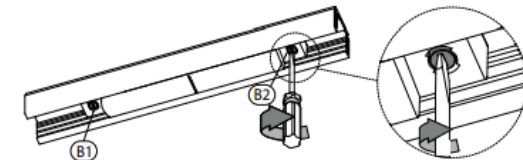

Fix it in place by turning the two mechanical twist locks with a screwdriver