

SUSPENSION / LUMIERE DE TABLEAU EDRU 600

Pendant / Picture light EDRU 600

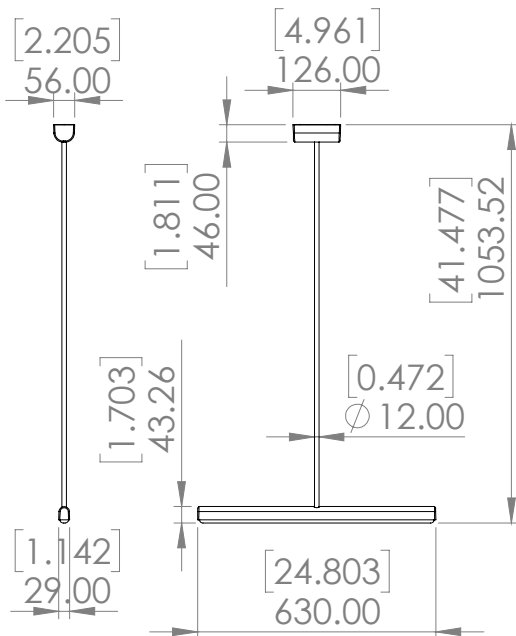

Référence
SUEU600LI

Description

Corps en bronze patiné - Vernis protecteur - Diffuseur en albâtre
220-240V / 50-60hz / 24V - LED non remplaçable / 5W

*Body lamp patinated bronze - Protective varnish - Alabaster diffuser
220-240V / 50-60hz / 24V - LED cannot be changed / 5W*



Spécificité

Specificity

Sources Lumens	strip LED 24V
Lumens	360 lm (nominal)
Watts	5
Poids kg (lbs) Weight	4 (9)
Certificats Certificates	 
Standard	    
Options	   
Couleurs Colors	  
Variation Dimming	  

Fixation

Fixing

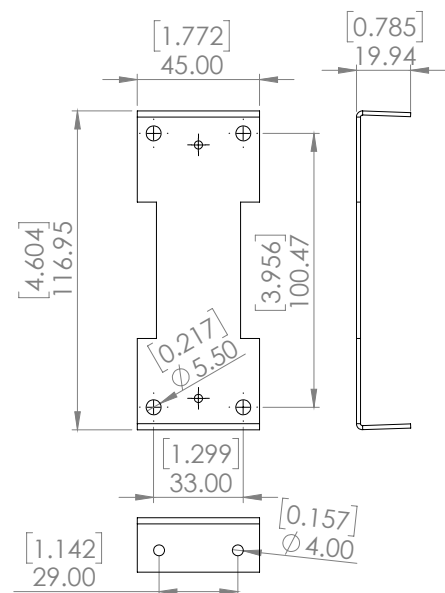

* Réglage atelier / Factory setting

Patines / Patinas



Albâtres / Alabasters



ENTRELACS