

technics

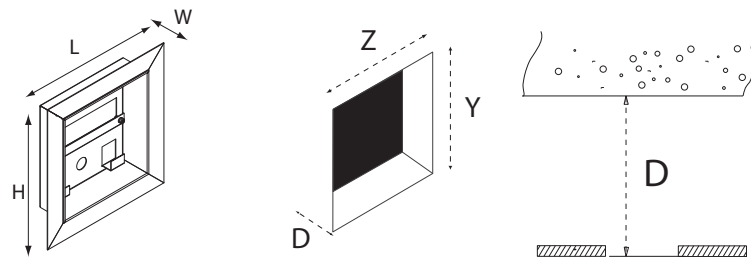

Name	Reference	LxHxW	ZxYxDmin
Rei 165	KR783010	239x249x53	180x190x55
Rei 300	KR783020	374x249x53	315x190x55

1 dimensions

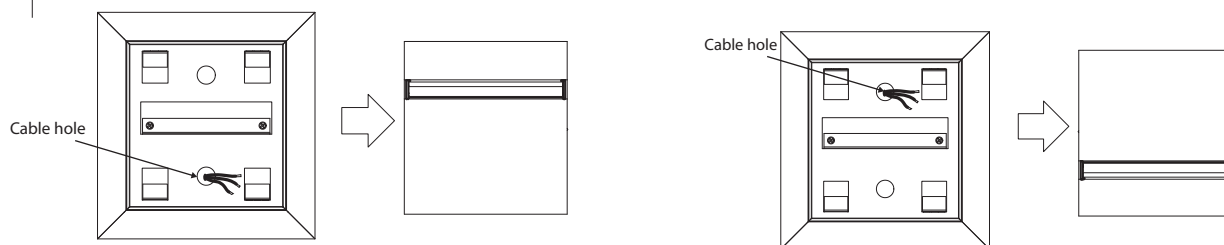

2 installation

Use bottom hole to guide the power cable when fixture is used as a downlight

Use upper hole to guide the power cable when fixture is used as an uplight

3 installation

Place the plasterkit in the hole.

Fix the plasterkit with plasterboard screws.

Fill around perimeter of plasterkit using suitable filler and plaster to hide screws and plasterkit.

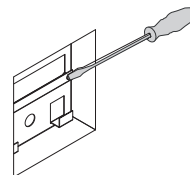
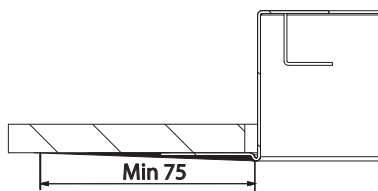

4 installation

Minimum filler distance, spread out until zero.

Unscrew the fixing screws and install the fixture, see manual KR8832101825.