

# kreon

technics		Name	Reference	Current
		Holon 45 directional recessed	KR96221x	700mA

1 dimensions		Name	Reference	Cut-out ØA	Visible Ø	B*	C
		aplis in-line 40 plasterkit	KR707104	Ø 63	Ø 40	35	**

\* installation depth B is in case the driver is placed at a distance, so doesn't need to be pushed through the plasterkit

\*\* installation depth C is in case the driver has to be pushed through the plasterkit in order to be close to the fixture. Mind that the driver dimensions WxH cannot exceed 35x19mm! the length of the driver determines C as it has to be pushed perpendicular through the plasterkit.  
Depth = length of the driver + 30mm  
If the length of the driver is e.g. 150mm - C = 180mm

3 installation plasterkit		<p>first install the plasterkit KR707104 put the plasterkit through the cut-out in the ceiling</p>	<p>Please make sure that sticker is removed before proceeding!</p>		<p>fix the plasterkit with the screws</p>		<p>assembling torque max 20 CN.m.</p>

installation plasterkit		<p>assembling principle</p>		<p>fill around perimeter of plasterkit using suitable filler and plaster to hide screws and plasterkit.</p>		<p>minimum filler distance, spread out until zero.</p>

## technics

Please make sure that main voltage is disconnected before proceeding! ⚡

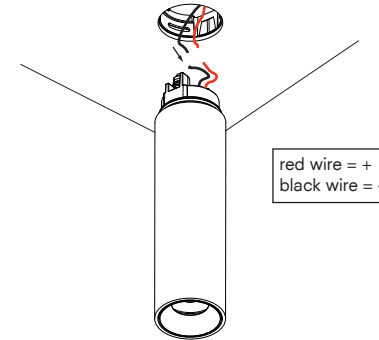
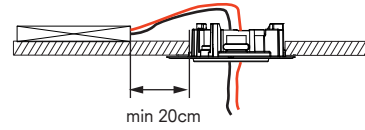
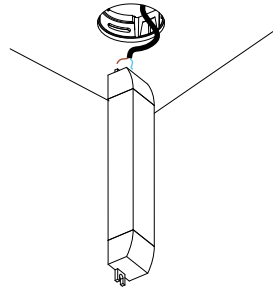

red wire = +  
black wire = -

## 4 electric connection

in case of driver:  
connect the mains supply to the driver and push the driver perpendicular through the plasterkit (make sure the check the remark on installation depth and driver on page 1)

connect the wires coming from the gear to the wires coming from the holon. Mind the polarity of the wires!

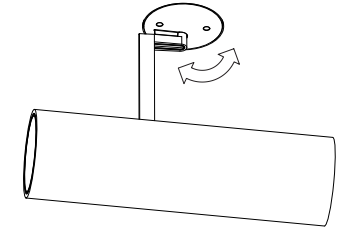
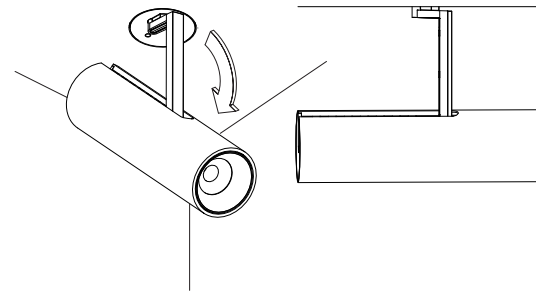
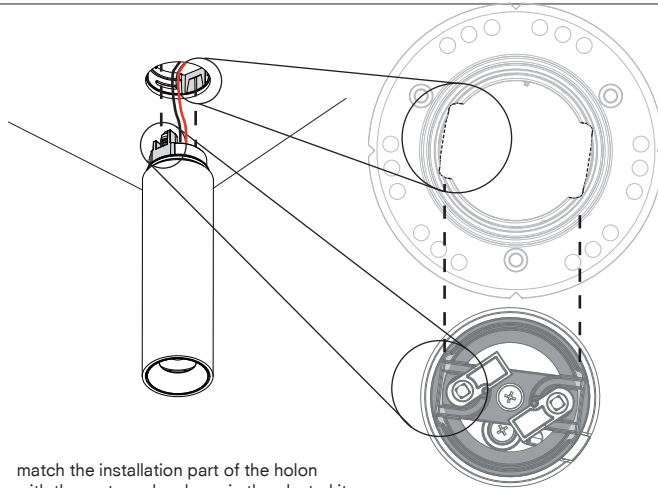

## 5 installation

match the installation part of the holon with the rectangular shape in the plasterkit

inclinate the tube by pulling it, to make space to reach the screwholes

rotate the fixture until the holes in the plate match the position of the screws in the installation part

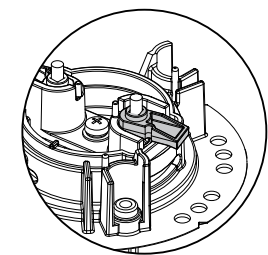
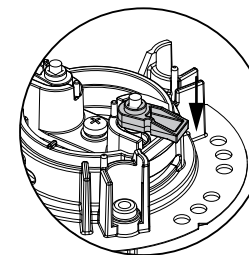
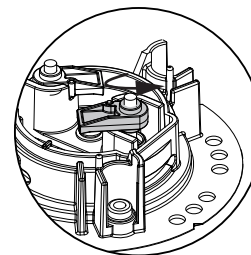
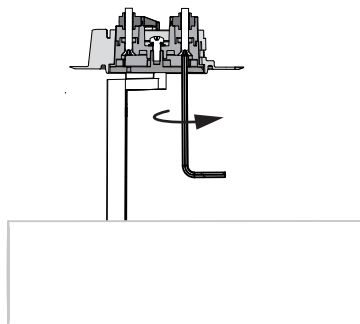
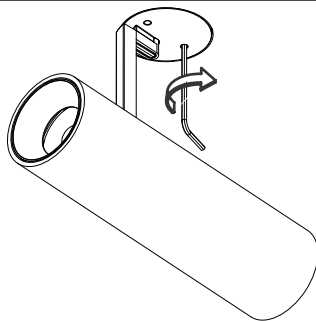

fix the complete fixture by turning the screws

assembly principle

## technics

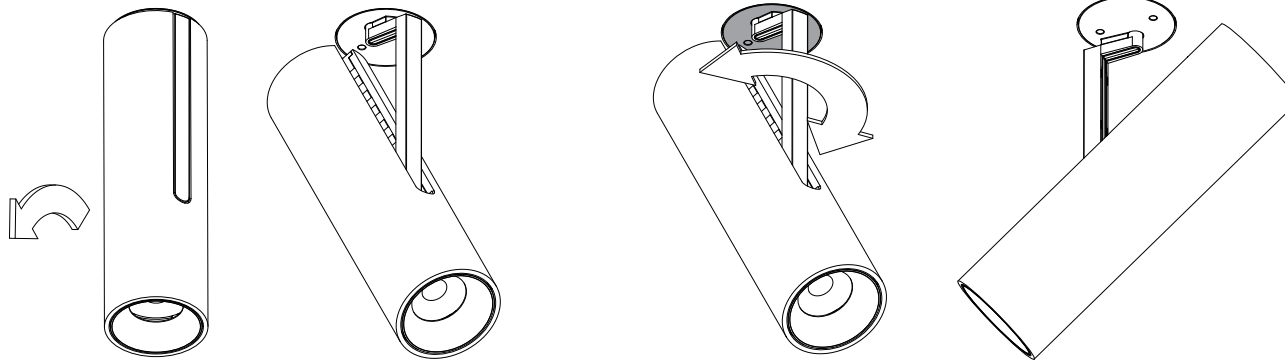

## installation

once the holon is completely installed  
it can be inclined in any angle up to 90° by pullin the tube

it can also be rotated for 330°

KR762000

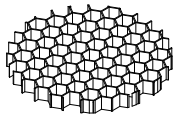

KR762100

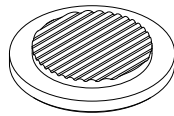

KR762200

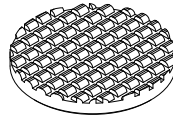

## 6 accessories

in case of accessories  
check the manual KR8622102021 delivered with the accessory  
only one accessory per holon

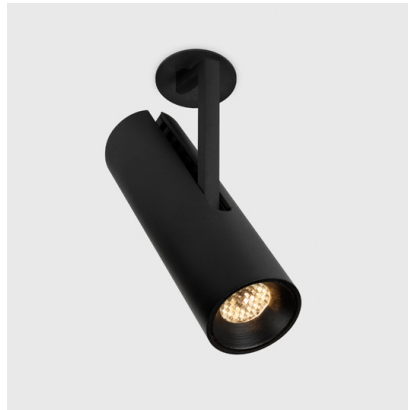
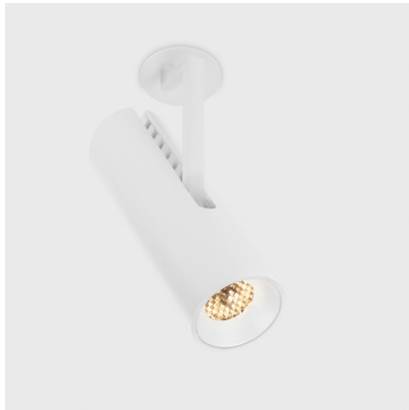

## 7 pictures

kreon nv

Industrieweg Noord 1152  
3660 Opglabbeek  
Belgium

Tel + 32 89 81 97 80  
Fax + 32 89 81 97 90

www.kreon.com  
mailbox@kreon.be

revision date: 16/07/14  
KR8622102017

Sheet 2/3