

<p>technics</p>	<p>Small Diapason</p> 	<table border="1"> <thead> <tr> <th>Name</th> <th>Reference</th> <th>L x W x D</th> </tr> </thead> <tbody> <tr> <td>Small Diapason QR-CBC51</td> <td>KR97610x</td> <td>105 x 104 x Ø72</td> </tr> <tr> <td>Small Diapason QPAR16</td> <td>KR97616x</td> <td>205 x 104 x Ø72</td> </tr> <tr> <td>Small Diapason HIPAR16</td> <td>KR97666x</td> <td>105 x 140 x Ø72</td> </tr> <tr> <td>Small Diapason HIPAR20</td> <td>KR97656x</td> <td>105 x 104 x Ø72</td> </tr> <tr> <td>Small Diapason LED</td> <td>KR97640x</td> <td>105 x 140 x Ø72</td> </tr> </tbody> </table>	Name	Reference	L x W x D	Small Diapason QR-CBC51	KR97610x	105 x 104 x Ø72	Small Diapason QPAR16	KR97616x	205 x 104 x Ø72	Small Diapason HIPAR16	KR97666x	105 x 140 x Ø72	Small Diapason HIPAR20	KR97656x	105 x 104 x Ø72	Small Diapason LED	KR97640x	105 x 140 x Ø72	
Name	Reference	L x W x D																			
Small Diapason QR-CBC51	KR97610x	105 x 104 x Ø72																			
Small Diapason QPAR16	KR97616x	205 x 104 x Ø72																			
Small Diapason HIPAR16	KR97666x	105 x 140 x Ø72																			
Small Diapason HIPAR20	KR97656x	105 x 104 x Ø72																			
Small Diapason LED	KR97640x	105 x 140 x Ø72																			
<p>1 dimensions</p>	 <p>apply correct current</p> <p>ATTENTION: * always use correct gear, use high voltage cable between gear and lamp and use a high voltage connector (not supplied with fixture) ** connect red wire with + on the gear connect black wire with - on the gear</p> <div style="border: 1px solid black; padding: 5px; width: fit-content;"> <p>WARNING the led will be destroyed if not connected correctly! respect polarity!!</p> </div>	<table border="1"> <thead> <tr> <th>Name</th> <th>Reference</th> <th>Voltage ⚡</th> </tr> </thead> <tbody> <tr> <td>Small Diapason QR-CBC51</td> <td>KR97610x</td> <td>12V</td> </tr> <tr> <td>Small Diapason QPAR16</td> <td>KR97616x</td> <td>230V</td> </tr> <tr> <td>Small Diapason HIPAR16*</td> <td>KR97666x</td> <td>230V/5kV</td> </tr> <tr> <td>Small Diapason HIPAR20*</td> <td>KR97656x</td> <td>230V/5kV</td> </tr> <tr> <td>Small Diapason LED**</td> <td>KR97640x</td> <td>12V/700mA</td> </tr> </tbody> </table> <div style="border: 1px solid black; padding: 5px; width: fit-content;"> <p>Please make sure that main voltage is disconnected before proceeding! ⚡</p> </div>	Name	Reference	Voltage ⚡	Small Diapason QR-CBC51	KR97610x	12V	Small Diapason QPAR16	KR97616x	230V	Small Diapason HIPAR16*	KR97666x	230V/5kV	Small Diapason HIPAR20*	KR97656x	230V/5kV	Small Diapason LED**	KR97640x	12V/700mA	
Name	Reference	Voltage ⚡																			
Small Diapason QR-CBC51	KR97610x	12V																			
Small Diapason QPAR16	KR97616x	230V																			
Small Diapason HIPAR16*	KR97666x	230V/5kV																			
Small Diapason HIPAR20*	KR97656x	230V/5kV																			
Small Diapason LED**	KR97640x	12V/700mA																			
<p>2 connection</p>	<p>installation of diapason</p>  <p>provide hole Ø10mm</p>		<p>Always make sure the highest black ring is mounted against the Diapason</p>																		
<p>3 installation</p>	<p>base is <u>optional</u> in tile system base is <u>required</u> in gypsum system</p>  <p>Ø5 mm</p> <p>base: check instructions on optional base manual (kr8765001535) for correct installation</p>	 <p>gearbox : check instructions on gearbox manual (kr8965001357) for correct installation.</p>																			
<p>4 installation</p>																					

5 installation

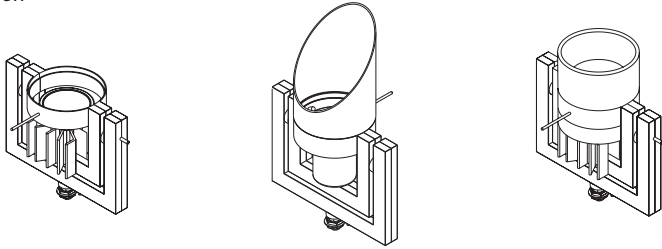
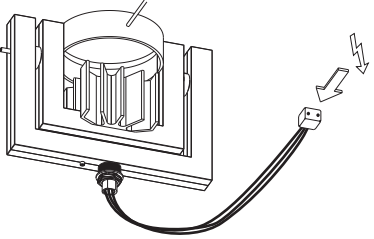
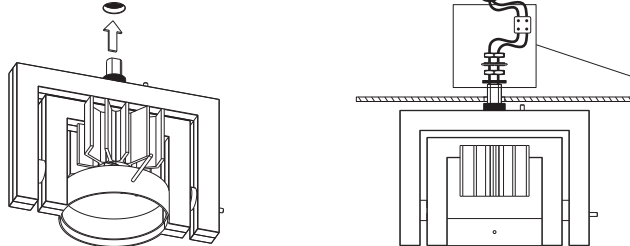
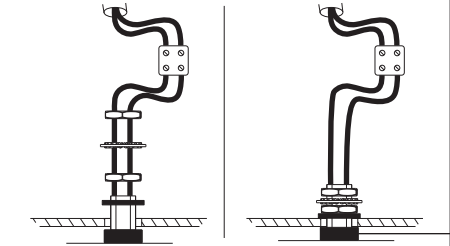
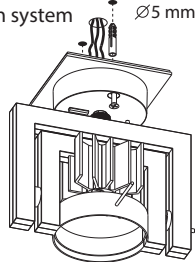
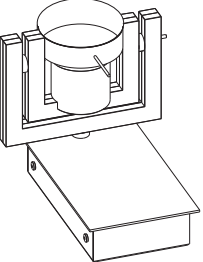
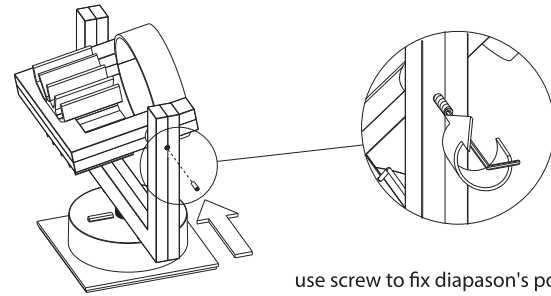

use screw to fix diaphragm's position

6 accessories

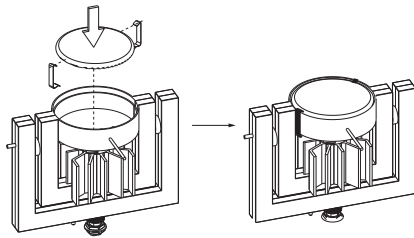

lens, glass or filter :
fix to frame with springs

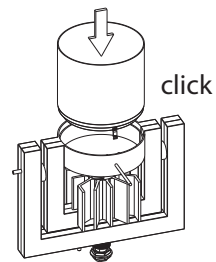

glare preventer : push until it snaps

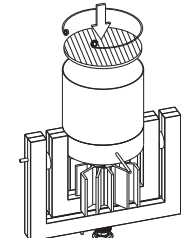

glare preventer + lens, glass or filter:
use fixation spring

7 picture



technics

Optional base

Name

Reference

DIAPASON ROUND BASE

kr77600x

DIAPASON SQUARE BASE

kr77601x

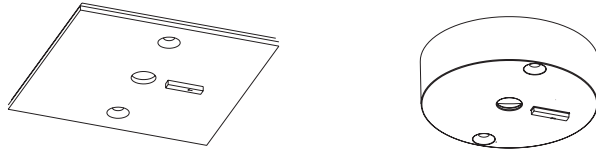

Please make sure that mains voltage is disconnected before proceeding! ⚡

1 reference

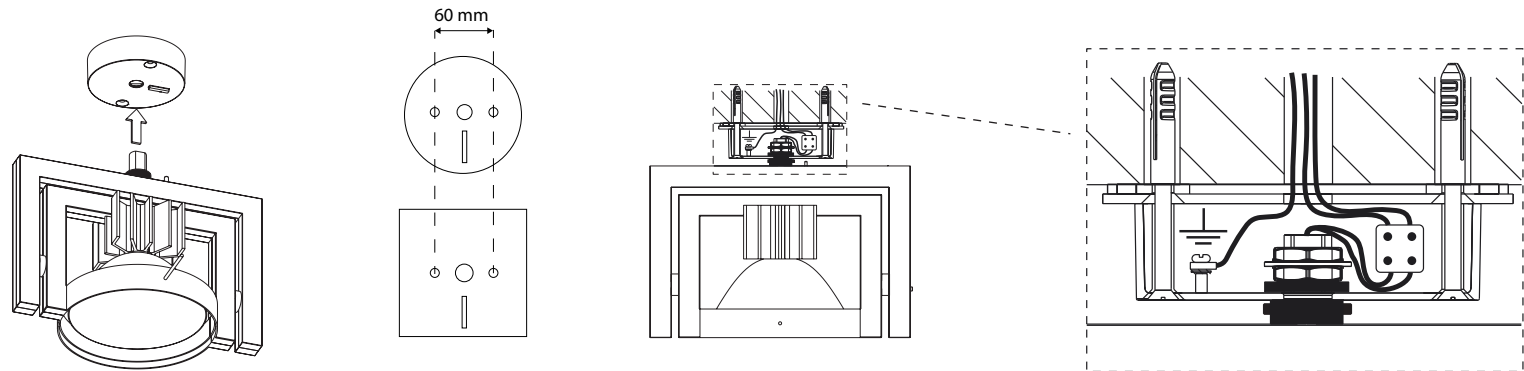

2 connection

for round base:

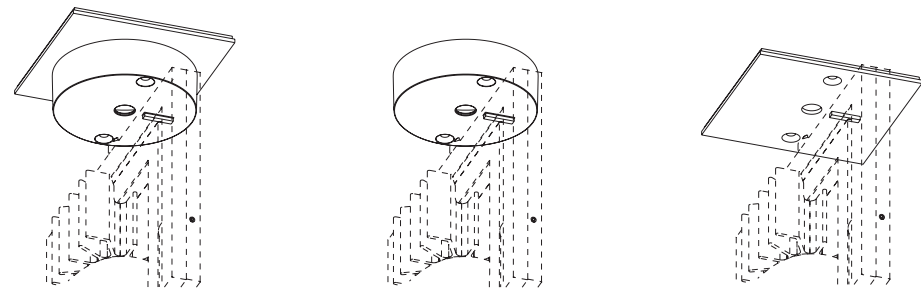
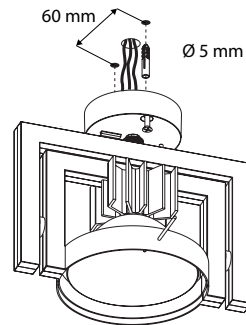

3 installation

place diapason base on ceiling or wall

choose between the different mounting possibilities

kreon nv

Industrieweg Noord 1152
B 3660 Oplabbeek
Belgium

Tel +32-89-81 97 80
Fax +32-89-81 97 90

www.kreon.com
mailbox@kreon.be

rev. date: 01/01/2009
KR8765001535

technics

diapason gearbox

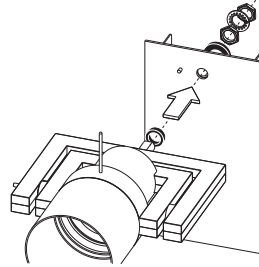
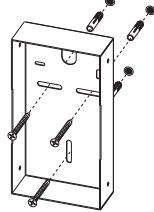

Always make sure the highest black ring is mounted against the Diapason

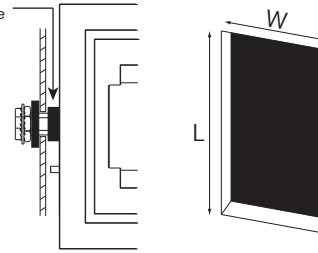

Reference	Lampwattage	Dimensions	Cut Out L x W
kr99620x	no gear	190 x 105 x 43	180 x 95
kr99654x	no gear	190 x 105 x 43	180 x 95
kr99664x	no gear	255 x 105 x 43	245 x 95
kr99615x	1 x 20W	170 x 80 x 43	160 x 70
kr99611x	20 - 50W	170 x 80 x 43	160 x 70
kr99616x	1 x 35W	170 x 80 x 43	160 x 70
kr99612x	35 - 105W	170 x 80 x 43	160 x 70
kr99655x	1 x 20W	190 x 105 x 43	180 x 95
kr99621x	35 - 105W	190 x 105 x 43	180 x 95
kr99656x	1 x 35W	190 x 105 x 43	180 x 95
kr99657x	1 x 70W	190 x 105 x 43	180 x 95
kr99666x	2 x 35W	255 x 105 x 43	245 x 95
kr99662x	50 - 150W	255 x 105 x 43	245 x 95
kr99645x	1x 10W	170 x 80 x 43	160 x 70

1 installation

for installation on the wall:
provide holes and fix with screws

fix the diapason to the lit

cut out for wall installation

Please make sure that mains voltage is disconnected before proceeding!

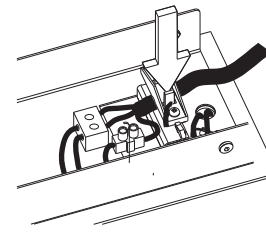
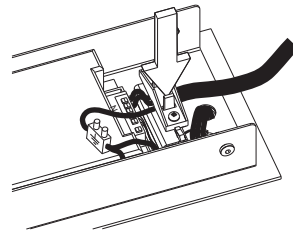

connect line cables to gear and earth cable to connector. fix strain relief to jam cable

in case of no gear : connect line cables and earth cable to connector. fix strain relief to jam cable

2 connection

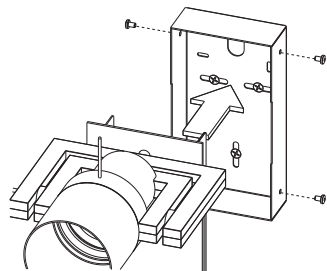

close the lit and fasten with screws

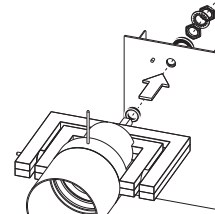

fix the diapason to the lit and make connection with the gear
in case of LED-driver kr99635x: connect red wire with + and black wire with -

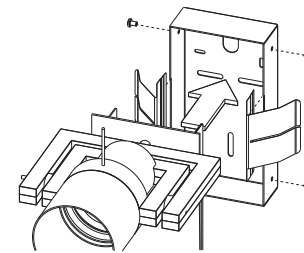

place the springs on the housing.
close the lit and fasten with screws

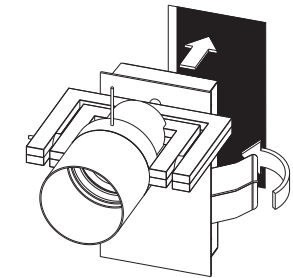

fold the springs inward and place in hole

3 installation

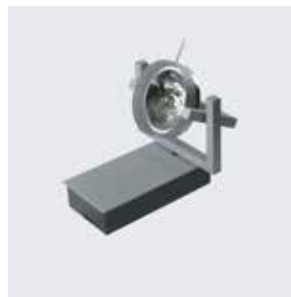

4 pictures

kreon nv

Industrieweg Noord 1152
3660 Oplabbek
Belgium

Tel + 32 89 81 97 80
Fax + 32 89 81 97 90

www.kreon.com
mailbox@kreon.be

Rev.date: 12/10/2016
KR8965001357