

Name: Spock Mini

Design: Christophe Mathieu / 2011

Typology: Table lamp

Environment: Indoor

Technical description:

Table lamp with zamac mold-injected hood, housing four 1.2W LED bulbs, coated in satin nickel, brilliant chrome, chrome with white trim, or chrome with graphite trim, fastened to a stainless steel base that allows swivel arm to rotate 360 degrees, and a base rotation of 25 degrees. Zamac hood swivels 50 degrees from base, and rotates 360 degrees on stem. Electrical cord includes switch. Includes sanded borosilicate glass diffuser.



Lamps description

⦿ 3.6 W LED
Led: 12 x 0.3 W = 3.6 W
Lumens: 444 lm @80°C
CRI: 90
Degrees Kelvin: 3000°

Voltage: 100-240V~50/60Hz

📦 1 Box 8.66 x 8.66 x 14.96 inches

Vol.: 0.0.6498 ft³

Weight: 5.51 lbs

Certifications: ETL CE

Photometrics made according to the position the lights are shown in the catalogue and price list.

Ref Finishings

2010512LU Led Chrome
2010511LU Led Chrome-White

Zamac injected orientable hood

Stainless steel base

Black wire + switch

Diffuser: Circular rotation 360° / Vertical rotation 50°

Mast: Circular rotation 360° / Mast inclination 25°

Not Customizable

Measures

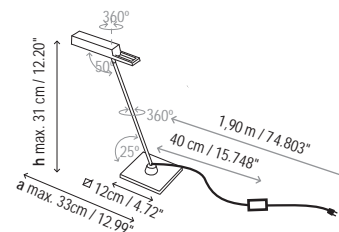

Spock - T

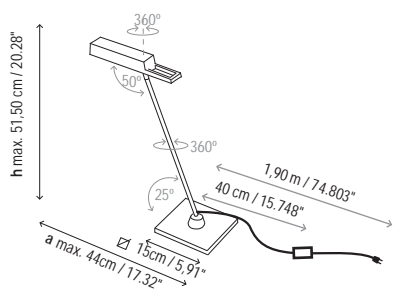

Spock - Mini

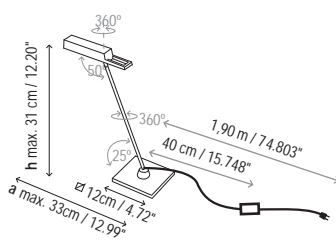

Spock - A

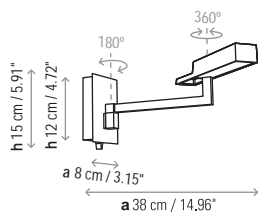

Spock - P

