

hoverinfo@boverusa.com
www.boverusa.com**Spock - T**

Name: Spock - T

Design: Christophe Mathieu / 2007

Typology: Table lamp

Environment: Indoor

Technical description:

Table light with zamac mold-injected hood, housing four 1.2W LED bulbs, coated in satin nickel, brilliant chrome, chrome with white trim, or chrome with graphite trim, fastened to a stainless steel base that allows swivel arm to rotate 360 degrees, and a base rotation of 25 degrees. Zamac hood swivels 50 degrees from base, and rotates 360 degrees on stem. Electrical cord includes switch. Includes sanded borosilicate glass diffuser.



Lamps description

3.6 W LED
Led: 12 x 0.3 W = 3.6 W
Lumens: 444 lm @80°C
CRI: 90
Degrees Kelvin: 3000^o

Voltage: 100-240V~50/60Hz

1 Box 10.63 x 5.91 x 20.47 inches

Vol.: 0.7451 ft³

Weight: 6.61 lbs

Certifications: ETL CE

Photometrics made according to the position the lights are shown in the catalogue and price list.

Ref Finishings

1910512LU Led Chrome

1910511LU Led Chrome-White

Zamac injected orientable hood

Stainless steel base

Black wire + switch

Diffuser: Circular rotation 360^o / Vertical rotation 50^oMast: Circular rotation 360^o / Mast inclination 25^o

Not Customizable

Measures

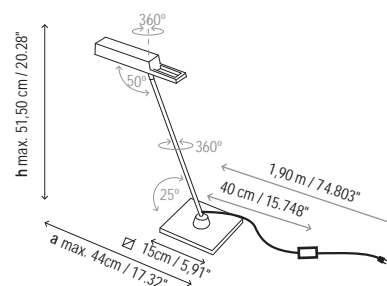

Spock - T

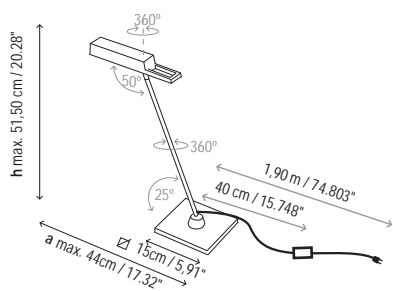

Spock - Mini

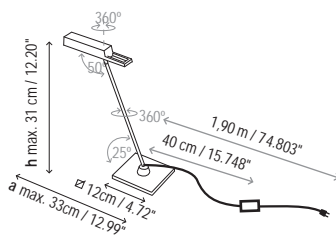

Spock - A

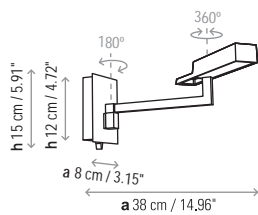

Spock - P

