

Name: Spock - A

Design: Christophe Mathieu / 2007

Typology: Wall lamp

Environment: Indoor

Technical description:

Wall light with zamac mold-injected hood, housing four 1.2W LED bulbs, coated in satin nickel, brilliant chrome, chrome with white trim, or chrome with graphite trim. Brass structure in arm provides sharp, clean angles, and brass swivel arm rotates 360 degrees. Zamac hood swivels 50 degrees from base. Includes sanded borosilicate glass diffuser. Electrical switch is located on base. Only fixture finishing is customizable.



Lamps description

 Grounding: compulsory

 4.8 W LED
Led: 4 x 1.2 W = 4.8 W
Lumens: 85 x 4 = 340 lm
CRI: 90
Degrees Kelvin: 2900°

Voltage: 120 V~60 Hz

 1 Box 18.90 x 5.91 x 9.84 inches

Vol.: 0.63566 ft³

Weight: 3.31 lbs

Certifications:  

 Photometrics made according to the position the lights are shown in the catalogue and price list.

Ref Finishings

1110505LU	Nickel
1110506LU	Chrome
1110511LU	Chrome-White

Surface back box 4.7" x 3.1"

IMPORTANT NOTE
Must mount vertically 2" x 4"

Measures

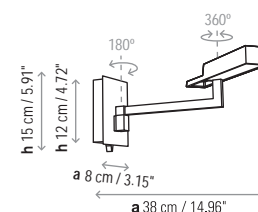

Spock - T

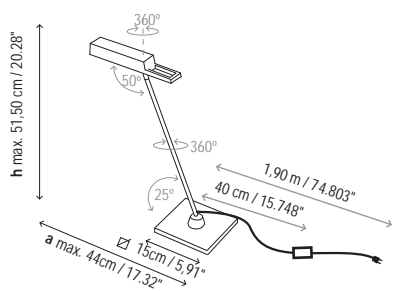

Spock - Mini

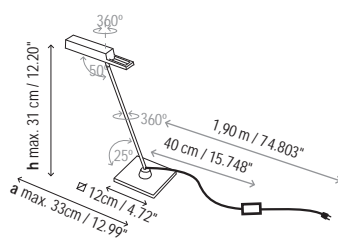

Spock - A

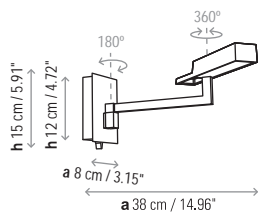

Spock - P

