

technics		Name	Reference	Drive current
		Aplis 120 LED low	KR95793x-83xx-SP	700mA
1 dimensions		Aplis 120 LED low	KR95793x-83xx-FL/WFL	700mA
		Aplis 120 LED low	KR95793x-98xx-SP/FL/WFL	700mA

The luminaire must not under any circumstances be covered with heat insulating covers or similar materials.  
Cables must not touch the luminaire housing.  
The connection cable must be routed so that it does not touch the lamp when the luminaire is tilted.

2 cut out		Name	Reference	ØA	CxD	E min	T <sub>min</sub> -T <sub>max</sub>	
		Aplis 120 LED low	KR95793x-83xx-SP	128	390x390	140		
		Aplis 120 LED low	KR95793x-83xx-FL/WFL	128	390x390	140		
		Aplis 120 LED low	KR95793x-89xx-SP/FL/WFL	128	390x390	140		
		Plasterboard thickness					9-26	

3 installation	<p>Remove louvre</p>	<p>Remove LED module by pressing the four springs inwards</p>	<p>Open spring mechanisme (3x) with an allen key.</p>	<p>1. Push key into hole 2. Pull downwards</p>
----------------	----------------------	---	---	--

4 installation	<p>Insert installation box in the hole.</p>	<p>Close spring mechanisme (3x) by pushing inwards.</p>	<p>click ! Fix the spring with a tool.</p>	
----------------	---	---	--	--

technics

Please make sure that main voltage is disconnected before proceeding!

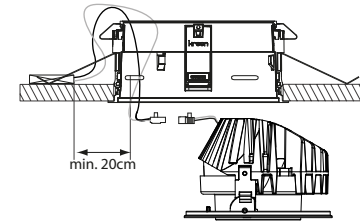
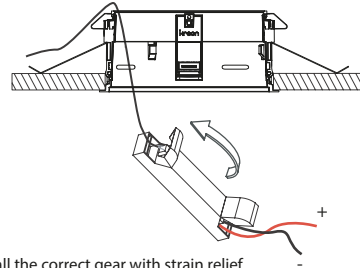

5 installation

install the correct gear with strain relief on the hollow ceiling

important: always check the polarity!!  
+ = red wire - = black wire

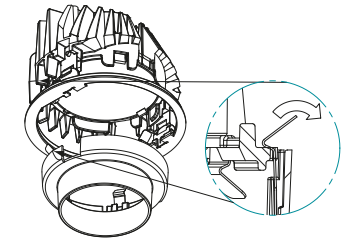
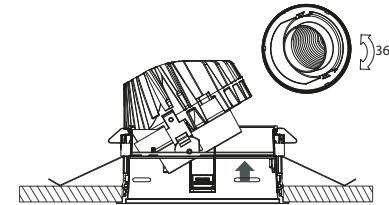
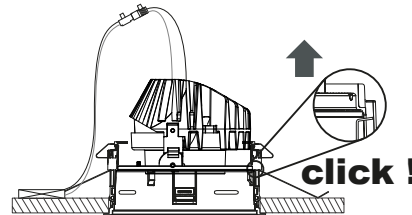
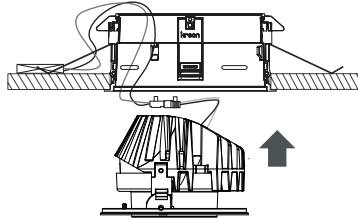

6 installation

Put the assembly in the plasterkit.

push filterholder to rotate and turn inner part manually

Optional:  
In case of adding a filter.

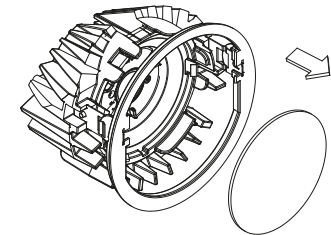
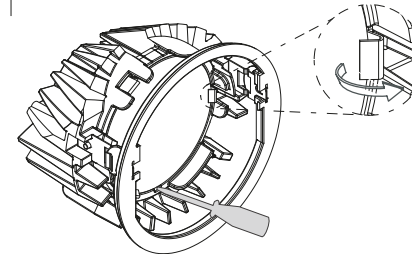
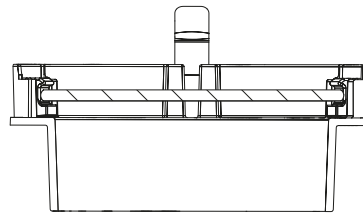
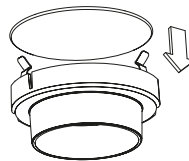

7 installation

Add extra filter to the filterholder.

Maximum capacity= one filter

In case of lens replacement bend the springs to remove the lens.

Remove the lens and add a new lens.

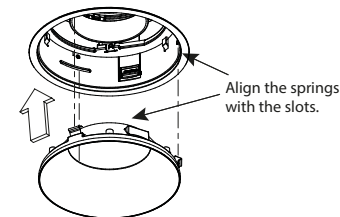
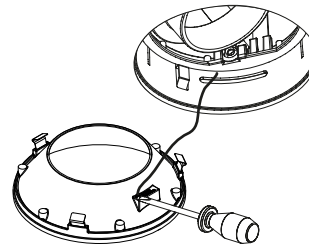
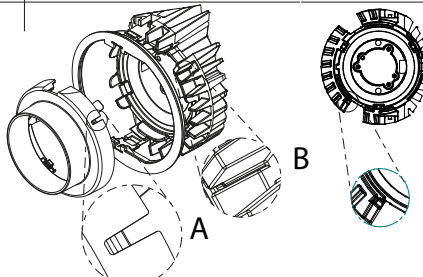

8 installation

When adding the filterholder align A (cutout) with B (rib).

Fix the fall safety cable with added screw to the louvre (in case not done yet).

Insert the louvre in the plasterkit