

technics		Name	Reference	Drive current
		Down 120 LED low	KR95798x-83xx-SP	700mA
1 dimensions		Down 120 LED low	KR95798x-83xx-FL/WFL	700mA
		Down 120 LED low	KR95798x-98xx-SP/FL/WFL	700mA

The luminaire must not under any circumstances be covered with heat insulating covers or similar materials.
Cables must not touch the luminaire housing.
The connection cable must be routed so that it does not touch the lamp when the luminaire is tilted.

2 cut out		Name	Reference	AxB	CxD	E min	T _{min} -T _{max}
		Down 120 LED low	KR95798x-83xx-SP	128x128	400x400	140	
		Down 120 LED low	KR95798x-83xx-FL/WFL	128x128	400x400	140	
		Down 120 LED low	KR95798x-89xx-SP/FL/WFL	128x128	400x400	140	

Min dimension for cooling, gear inclusive

Plasterboard thickness 9-26

3 installation				
	Remove louvre	Remove LED module by pressing the springs inwards	Open spring mechanism (4x) with an allen key.	

4 installation				
	Insert installation box in the hole.	Close spring mechanism (4x).	Fix the spring with a tool.	

technics

Please make sure that main voltage is disconnected before proceeding!

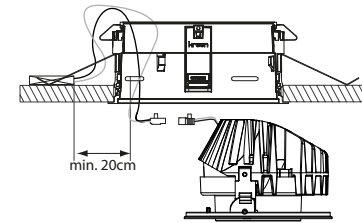
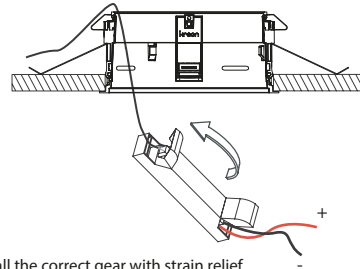

5 installation

install the correct gear with strain relief on the hollow ceiling

important: always check the polarity!!
+ = red wire - = black wire

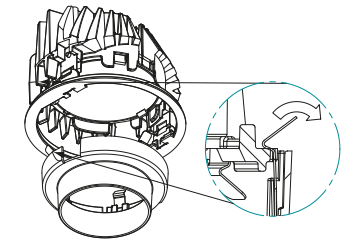
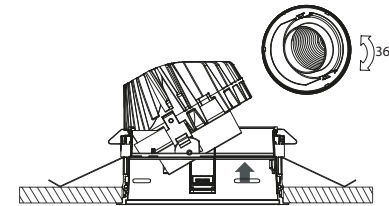
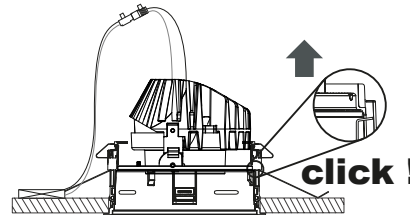
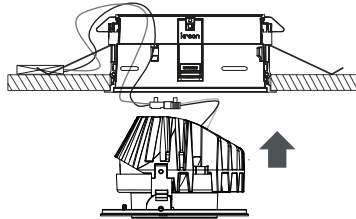

6 installation

Put the assembly in the plasterkit.

push filterholder to rotate and turn inner part manually

Optional:
In case of adding a filter.

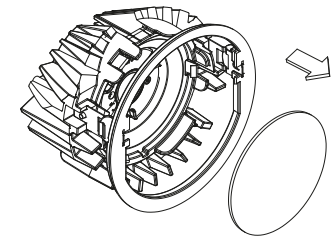
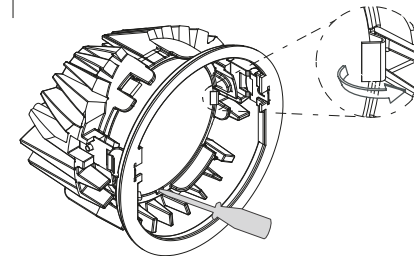
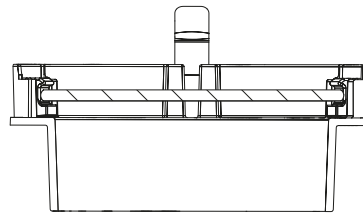
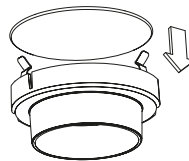

7 installation

Add extra filter to the filterholder.

Maximum capacity= one filters.

In case of lens replacement bend the springs to remove the lens.

Remove the lens and add a new lens.

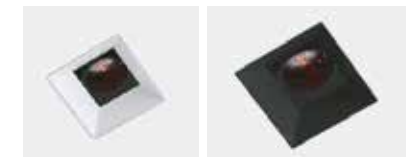
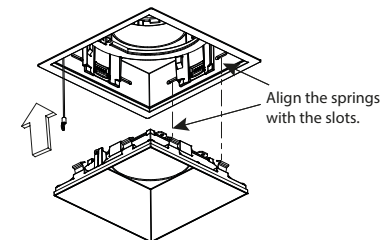
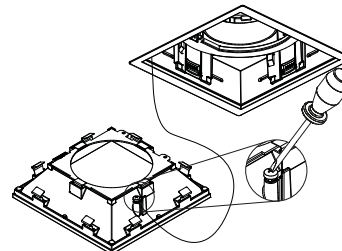
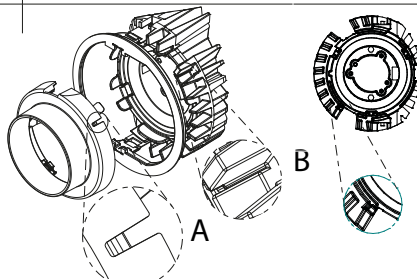

8 installation

When adding the filterholder align A (cutout) with B (rib).

Fix the fall safety cable with added screw to the louvre (in case not done yet).

Insert the louvre in the plasterkit